



FAST FLAPTM
NEUROSURGICAL FIXATION SYSTEM

distributed in the UK by

minim
healthcare



Rethinking Possibilities, Reshaping Lives

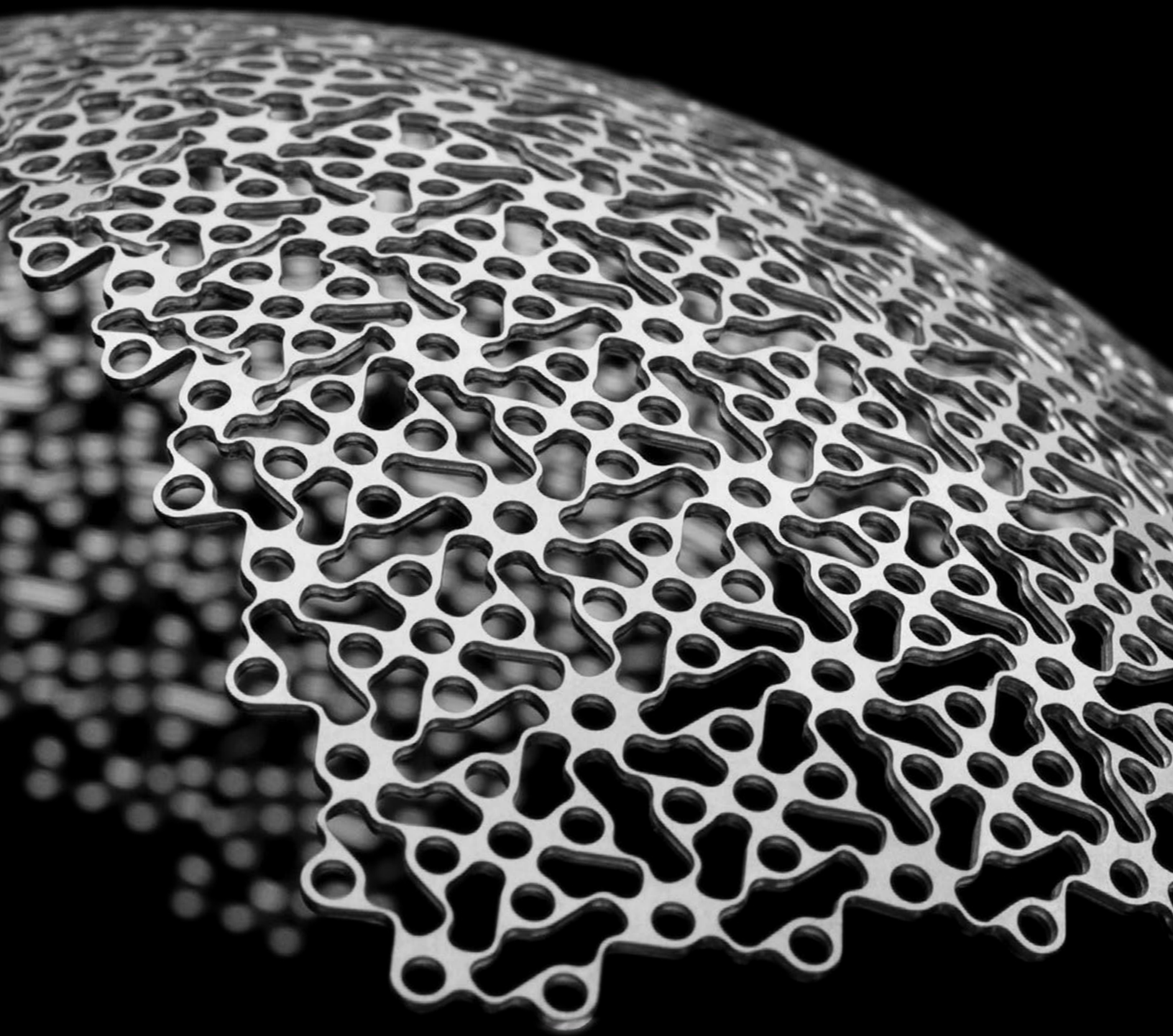

RETHINKING POSSIBILITIES, RESHAPING LIVES

At OsteoMed, we work alongside surgeons who devote their lives to improving those of others. Our goal: rethinking the possibilities that have the power to reshape lives.

With a spirit of innovation and a relentless focus on quality, we offer surgeons a wide range of choices for neurosurgical and craniomaxillofacial procedures.



Rethinking Possibilities, Reshaping Lives

UNIQUE • VERSATILE • COMPREHENSIVE

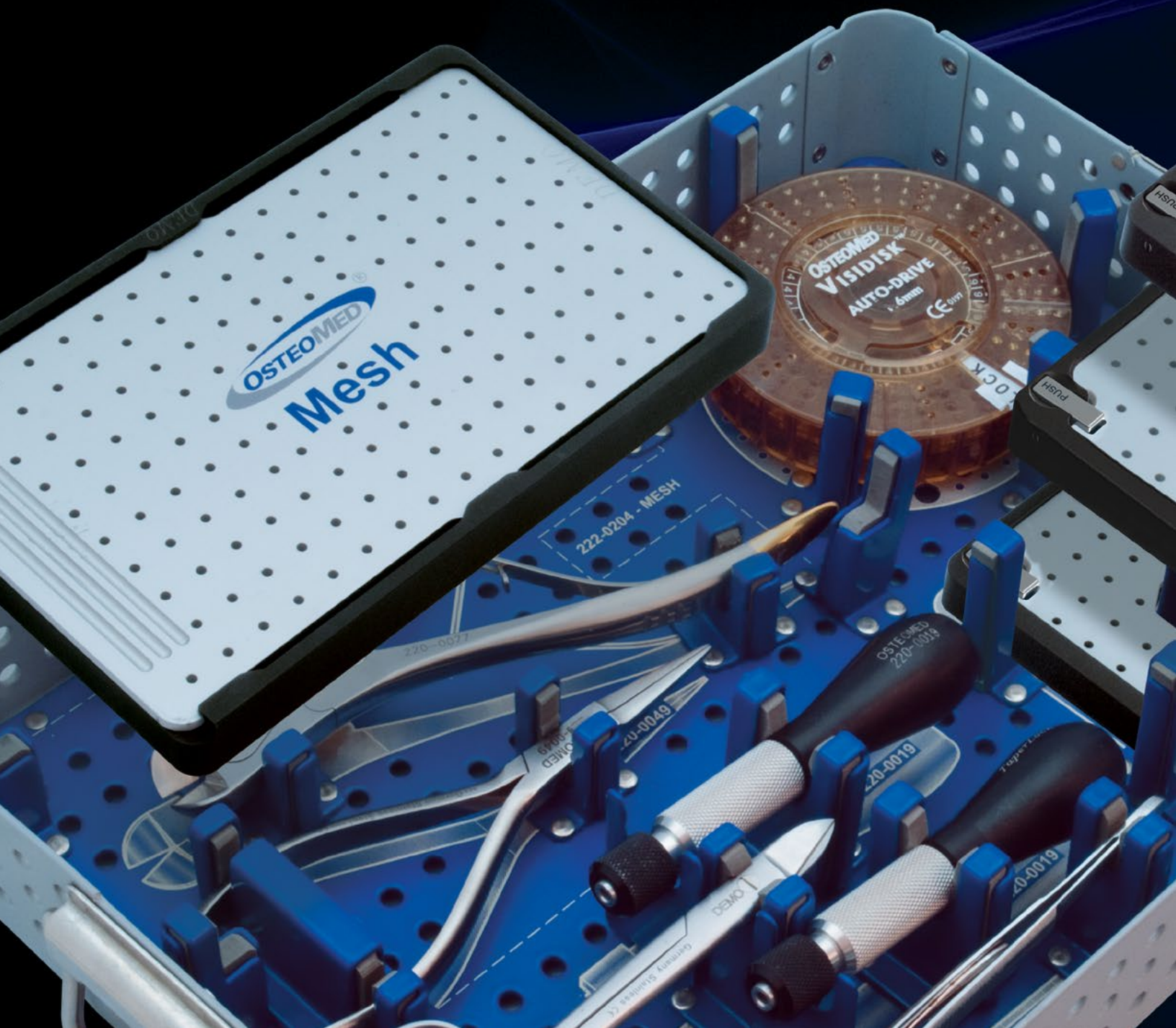

Interchangeable Blocks



1.2mm Block



1.6mm Low-Profile Block



1.6mm Block



Skull Base Block



Mesh Block



Fast-Flap System

Fast-Flap is a comprehensive plating system designed to address multiple neurosurgical approaches in one compact unit. From standard to low-profile plates, from skull base to meshes, Fast-Flap is the O.R.-friendly product contained in an intuitive modular housing. The Fast-Flap system includes all necessary instrumentation as well as OsteoMed's patented AutoDrive screws and VisiDisk screw caddy.





Fast-Flap Mesh System

OsteoForm Mesh allows for contouring and three-dimensional bending without creasing.

1.2mm Plates

Plate Profile: .5mm



212-0034 18 Hole Straight Plate
212-0038 5 Hole Straight Plate

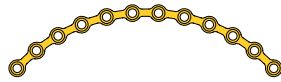

212-0036 12 Hole Curved Plate

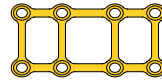

212-0040 2 x 4 Hole Quad Plate

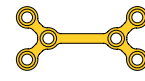

212-0138 Extended Double "Y" Plate



212-0130 Medium, 2 Hole, Straight Plate
212-0132 Long, 2 Hole, Straight Plate



212-0134 Square Plate



212-0136 Extended "X" Plate

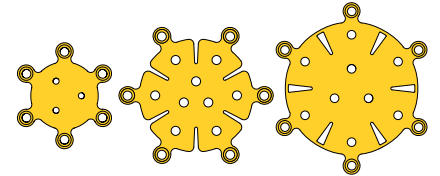

212-0140 Small Bur Hole Plate (Ø14.5mm)
212-0142 Large Bur Hole Plate (Ø22mm)
212-0144 X-Large Bur Hole Plate (Ø26mm)

1.2mm Auto-Drive Screws

Auto-Drive® Screws



P/N	Description
211-1203	1.2mm x 3mm Auto-Drive® Screw
211-1204	1.2mm x 4mm Auto-Drive® Screw
211-1205	1.2mm x 5mm Auto-Drive® Screw

Safety Screws



P/N	Description
204-1502	1.5mm x 2mm Safety Screw
204-1503	1.5mm x 3mm Safety Screw
204-1504	1.5mm x 4mm Safety Screw
204-1505	1.5mm x 5mm Safety Screw



222-0206 Fast-Flap, 1.2mm Implant Module

1.6mm Plates

Plate Profile: .5mm

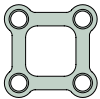

218-0020 9mm Square Plate



218-0022 Short 2 Hole Straight Plate
218-0024 Medium 2 Hole Straight Plate
218-0026 Long 2 Hole Straight Plate

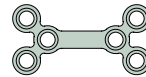

218-0028 Double "Y" Plate



218-0030 5 Hole Straight Plate
218-0038 10 Hole Straight Plate



218-0032 Small Bur Hole Plate (Ø14.5mm)



218-0033 Small Bur Hole Plate, Long Arm (Ø14.5mm)

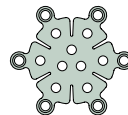

218-0034 Large Bur Hole Plate (Ø22mm)



218-0061 Bur Hole Shunt Plate

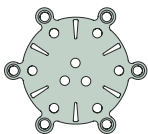

218-0062 X-Large Bur Hole Plate (Ø26mm)

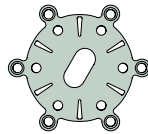

218-0064 Bur Hole Shunt Plate, Extended Hole



218-0069 Burr Hole Groove Shunt Plate



222-0207 Fast-Flap, 1.6mm Implant Module

1.6mm Low Profile Plates

Plate Profile: .25mm

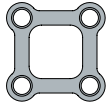

218-0090 1.6mm, Low Profile 9mm Square Plate



218-0091 1.6mm, Low Profile Short 2 Hole Straight Plate



218-0094 1.6mm, Low Profile Small Bur Hole Plate (Ø14.5mm)

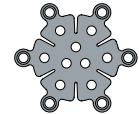

218-0095 1.6mm, Low Profile Large Bur Hole Plate (Ø22mm)

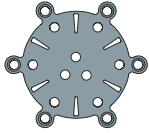

*218-0096 1.6mm, Low Profile X-Large Bur Hole Plate (Ø26mm)

218-0092 1.6mm, Low Profile Medium 2 Hole Straight Plate

218-0093 1.6mm, Low Profile Long 2 Hole Straight Plate

*Plate profile: .3mm

1.6mm Auto-Drive Screws

Auto-Drive® Screws



P/N	Description
211-1604	1.6mm x 4mm Auto-Drive® Screw
211-1605	1.6mm x 5mm Auto-Drive® Screw
211-1606	1.6mm x 6mm Auto-Drive® Screw

Safety Screws



P/N	Description
208-1904	1.9mm x 4mm Safety Screw
208-1905	1.9mm x 5mm Safety Screw
208-1906	1.9mm x 6mm Safety Screw



222-0209 Fast-Flap, 1.6mm Low-Profile Implant Module

Skull Base Plates

Plate Profile: .5mm

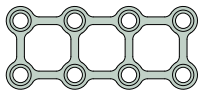

218-0059 2 x 3 Hole Quad Plate
218-0060 2 x 4 Hole Quad Plate

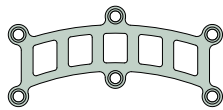

218-0042 25mm Gap Plate
218-0044 35mm Gap Plate
218-0046 45mm Gap Plate

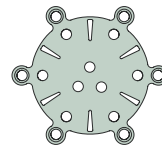

218-0062 X-Large Bur Hole Plate (Ø26mm)

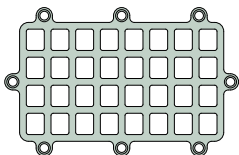

218-0048 21mm x 33mm Sub-Temporal Plate
218-0050 30mm x 48mm Sub-Temporal Plate



222-0208 Fast-Flap, Skull Base Implant Module

Plates are not actual size

Meshes

Box Pattern

OsteoForm Mesh®

1.2mm Malleable Meshes

- 212-0146 40mm x 40mm OsteoForm Mesh®, 1.2mm
- 212-0148 90mm x 90mm OsteoForm Mesh®, 1.2mm
- 212-0150 74mm x 50mm, Micro Mesh

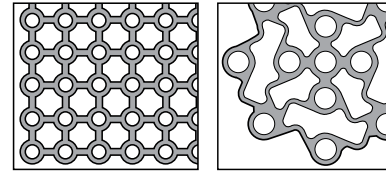

1.6mm Malleable Meshes

- 218-0036 36mm x 50mm Mesh Plate
- 218-0039 74mm x 50mm Mesh Plate
- 218-0040 111mm x 191mm Mesh Plate
- 218-0041 150mm x 300mm Mesh Plate
- 218-2001 40mm X 40mm Malleable OsteoForm Mesh® Plate
- 218-2003 90mm X 90mm Malleable OsteoForm Mesh® Plate
- 218-2001-SP 40mm x 40mm Malleable OsteoForm Mesh®, Sterile
- 218-2003-SP 90mm x 90mm Malleable OsteoForm Mesh®, Sterile

1.6mm Rigid Meshes

- 218-0052 74mm x 50mm Mesh Plate, Rigid
- 218-0053 125mm x 180mm Mesh Plate, Rigid
- 218-2002 40mm X 40mm Rigid OsteoForm Mesh® Plate
- 218-2004 90mm X 90mm Rigid OsteoForm Mesh® Plate
- 218-2007 165mm x 95mm Rigid OsteoForm Mesh® Plate
- 218-2014 165mm X 95mm OsteoForm® Mesh, Extra-Rigid
- 218-2002-SP 40mm x 40mm Rigid OsteoForm Mesh®, Sterile
- 218-2004-SP 90mm x 90mm Rigid OsteoForm Mesh®, Sterile







222-0204 Mesh Fast Flap Plate Organizer

Drills & Drivers

1.2mm Drills & Drivers

-  220-0022 1.2mm Screwdriver Shaft, Manual
-  220-0318 .9mm Pilot Drill, 3mm Stop, J-Latch
-  220-0319 .9mm Pilot Drill, 4mm Stop, J-Latch
-  220-0320 .9mm Pilot Drill, 5mm Stop, J-Latch

1.6mm Drills & Drivers

-  222-0004 1.1mm Pilot Drill, 4mm Stop, J-Latch
-  222-0005 1.1mm Pilot Drill, 4mm Stop, M
-  222-0006 1.1mm Pilot Drill, 6mm Stop, J
-  220-0086 1.6mm Screwdriver Shaft, Long
-  220-0061 1.6mm Screwdriver Shaft, Manual

Instruments



220-0077 Rigid Mini Plate Cutter



220-0049 Plate Bending Forceps



220-0019 TAPERLOCK™ Screwdriver Body



220-0086 1.6mm Screwdriver Shaft, Long, Manual

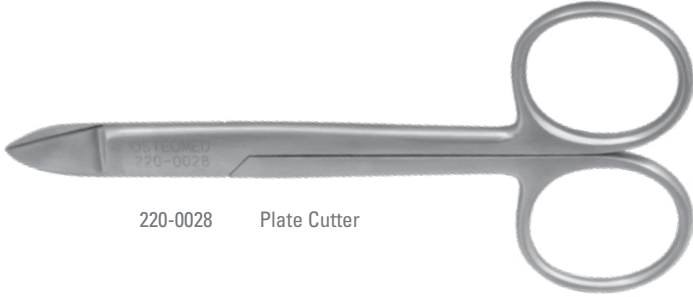

220-0028 Plate Cutter



220-0027 Small Grasping Forceps



Rethinking Possibilities, Reshaping Lives

OSTEOMED

3885 Arapaho Rd.
Addison, TX 75001
Customer Service: 800.456.7779
Customer Service Fax: 800.390.2620

www.osteomed.com

P/N 030-1500 Rev.E



available in the UK from

minim
healthcare

Newbury | Berkshire
+44(0)1635 528002
www.minimhealthcare.com